

Hatorq®-Rutschnaben

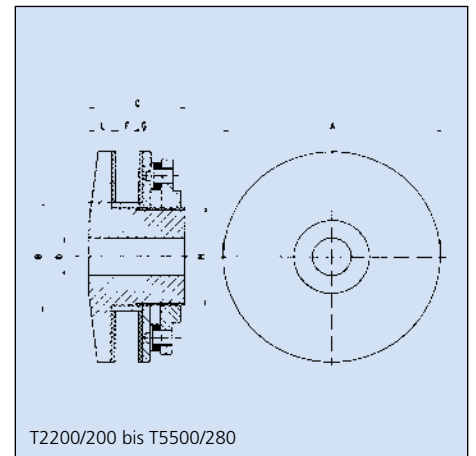
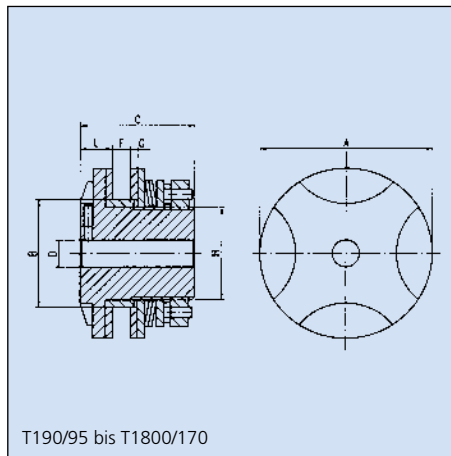
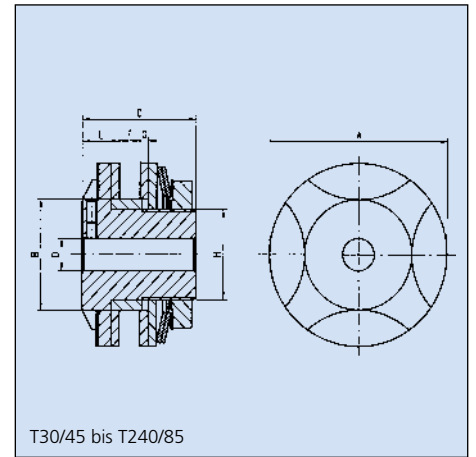
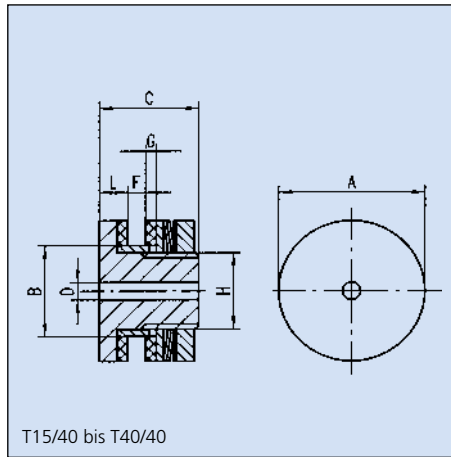

Abmessungen / Technische Daten

Artikel-Nr. Ketten Fuchs	Größe Mt × A	Übertragungs- werte	Anzahl Teller- feder	Abmessungen in mm			Bohrung		Antriebs- teilstärke F max. in mm	Abmessungen in mm			Gewicht kg	Massen- trägheits- moment kg cm ³
				A	B (k7)	C	D vor- gebohrt	D max. (H7)		Buchsen- länge in mm	G	H		
T 15/40	15 × 40	15,0	1	40,0	26,0	28,0	7,0	14,0	5,0 8,0	2,8	22,0	8,0	0,164	0,26
T 28/40	28 × 40	28,0	2	40,0	26,0	28,0	7,0	14,0	5,0 8,0	2,8	22,0	8,0	0,164	0,26
T 40/40	40 × 40	40,0	3	40,0	26,0	28,0	7,0	14,0	5,0 8,0	2,8	22,0	8,0	0,164	0,26
T 30/45	30 × 45	30,0	1	45,0	35,0	33,0	7,0	20,0	5,0 9,0	3,0	32,0	8,5	0,197	0,44
T 55/45	55 × 45	55,0	2	45,0	35,0	33,0	7,0	20,0	5,0 9,0	3,0	32,0	8,5	0,197	0,44
T 70/45	70 × 45	70,0	3	45,0	35,0	33,0	7,0	20,0	5,0 9,0	3,0	32,0	8,5	0,197	0,44
T 70/65	70 × 65	70,0	1	65,0	45,0	50,0	10,0	22,0	8,5 14,0	4,0	36,0	16,0	0,600	3,20
T 120/65	120 × 65	120,0	2	65,0	45,0	50,0	10,0	22,0	8,5 14,0	4,0	36,0	16,0	0,600	3,20
T 130/85	130 × 85	130,0	1	85,0	52,0	55,0	15,0	30,0	10,5 16,0	4,0	42,0	17,0	1,160	8,93
T 240/85	240 × 85	240,0	2	85,0	52,0	55,0	15,0	30,0	10,5 16,0	4,0	42,0	17,0	1,160	8,93
T 190/95	190 × 95	190,0	1	95,0	60,0	66,0	15,0	30,0	10,5 16,0	4,0	52,0	17,0	1,840	15,83
T 340/95	340 × 95	340,0	2	95,0	60,0	66,0	15,0	30,0	10,5 16,0	4,0	52,0	17,0	1,840	15,83
T 350/120	350 × 120	350,0	1	120,0	73,0	77,0	20,0	45,0	16,0 21,0	4,0	64,0	21,0	3,330	43,01
T 650/120	650 × 120	650,0	2	120,0	73,0	77,0	20,0	45,0	16,0 21,0	4,0	64,0	21,0	3,330	43,01